

imageRUNNER ADVANCE 6575i/6565i/6555i/6555i PRT

High quality, efficient and dependable

The imageRUNNER ADVANCE 6500 Series delivers high performance and quality black-and-white output for demanding office environments. These intelligent multifunctionals* enhance productivity through improved document workflows and an intuitive user experience.



Streamline document workflows

- Intuitive user interface with a large, responsive colour touchscreen with smart phone-like usability.
- Effortless, rapid scanning captures paper-based documents with ease.*
- Advanced personalisation enables a unique, personal experience tailored to meet each user's workflow needs.
- Canon's MEAP platform provides process optimisation, by integrating with a range of powerful document, capture* and output management solutions.
- Scalable support for mobile and flexible working styles allows workers to capture* or print documents and access certain cloud applications on the go.
- Scan and convert documents to Searchable PDF, Microsoft® Word, and Microsoft® PowerPoint files through a single-pass duplexing document feeder* that holds up to 300 originals.
- Motion sensor technology wakes device from sleep mode.
- Automatically remove blank pages when scanning*.
- Users can create professional-looking booklets and finished documents automatically.
- Convenient Staple-on-demand functionality.

Control Costs

- Technology designed to reduce total cost of print.
- Apply print policies, monitor output, and restrict usage by user.
- Tight integration with output management solutions, such as uniFLOW.
- Remote diagnostics and assistance, help reduce costs by minimising downtime and time spent by IT resolving issues.
- Remote and centralised fleet management simplifies IT management of devices and fleets.
- Options for cost recovery and coin vending integration.

Secure confidential information

- Control who has access to the device with Award-winning, smart user authentication without impacting on user productivity or convenience.
- Prevent unauthorised distribution of sensitive information with an array of standard and optional document security features.
- Ensure information privacy and security across your network with IPsec, port filtering capabilities, and SSL technology.
- Secure Print and Mailbox enhance document confidentiality.
- Ability to disable functions by user to prevent unauthorised usage.
- Industry-first Data Loss Prevention and auditing of prints, copies, scans and faxes through uniFLOW.

*Not applicable for the 6555i PRT



PRINT



COPY*



FAX*

Optional on
6555i/6565i/6575i



SCAN*

The Canon logo in red, featuring the word "Canon" in a bold, sans-serif font.

Manage devices efficiently

- Pre-configure devices making installation easy.
- Simplified fleet management by synchronising settings across multiple devices.
- Canon's device management tools give you a centralised point of control across your entire fleet, upgrade devices, check device status and consumables, turn off devices remotely, capture meter readings, as well as manage address books and printer drivers.
- Supports industry network standards i.e. PCL and Adobe PostScript for seamless integration.
- Shares resources and functionality with other imageRUNNER ADVANCE devices on the network.
- Collaborates with business applications and external systems in the Cloud.
- Remote diagnostics allow preventive maintenance.

Reliable results

- Canon's signature reliability and engine technologies provide high quality output to meet the needs of busy departments.
- State-of-the-art imaging technologies and toner allow for consistently striking images in rich black-and-white tones and 1,200 dpi. print resolution.
- Designed to achieve maximum uptime with intuitive user maintenance videos and status notifications, to help keep supplies replenished.

Environmentally responsible

- Fusing technologies, pO toner, and innovative sleep mode features help lower overall energy consumption.
- Minimise waste with default 2-sided printing, secure printing, and the ability to hold print jobs, preview them and change print settings at the device, achieving the desired results at the first time of printing.
- Incorporates sustainable design, with the use of recycled materials and bio-based plastic, and a focus on minimising environmental impact.
- ENERGY STAR® qualified.
- Reduce waste with Staple-less Eco stapler.
- Consumes as little as 0.9 in sleep mode.
- Class leading Typical Electricity Consumption (TEC*) ratings.

Configuration

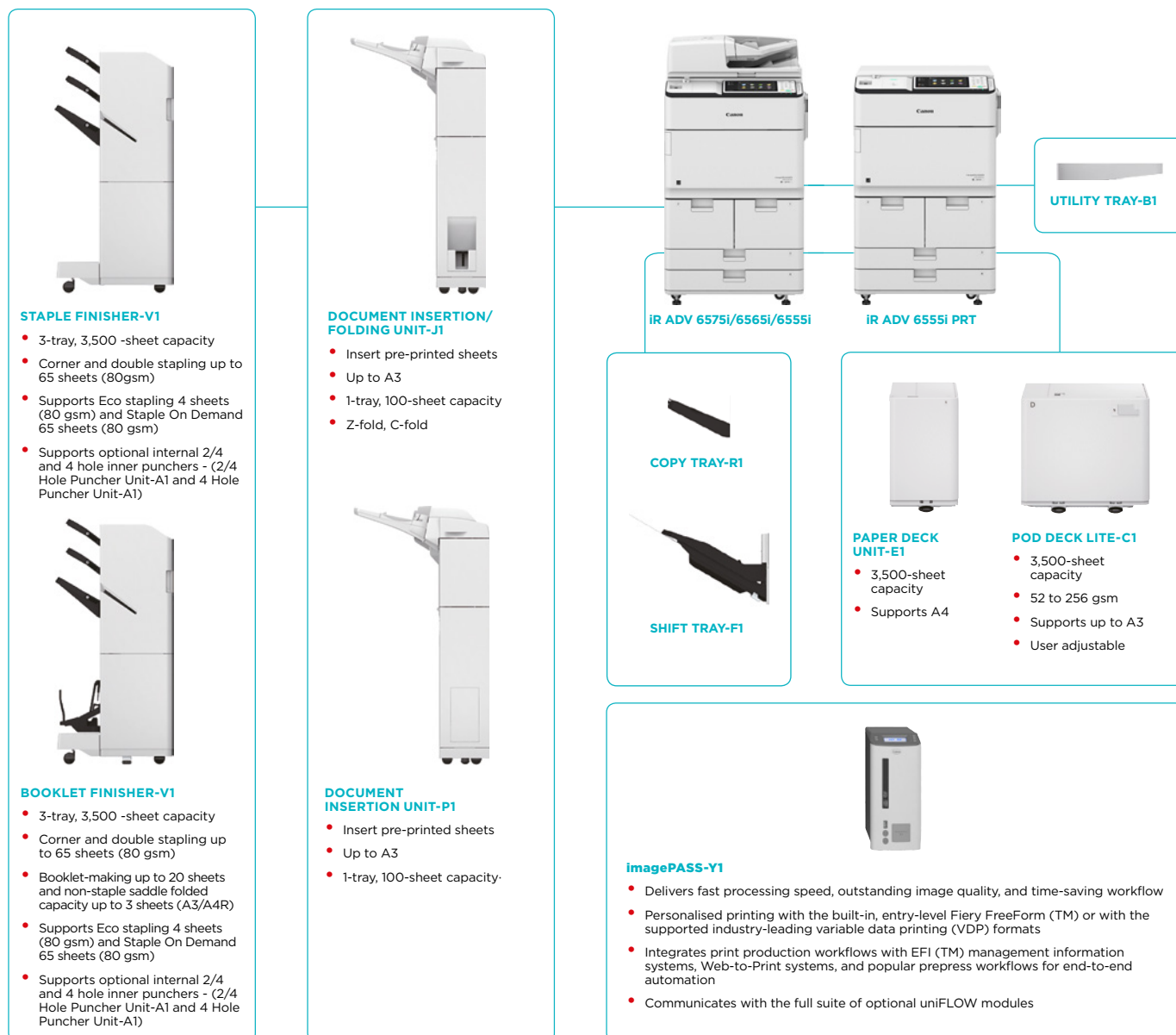

This flat configuration is for illustration purpose only. For a complete list of options and the exact compatibility relationships, please refer to the online product configurator.

Technical Specifications

imageRUNNER ADVANCE 6575i/6565i/6555i/6555i PRT

Main Unit

| | |
|--------------------------------------|---|
| Machine type | Monochrome Laser Multifunctional Printer |
| Core functions | Print, Copy, Scan, Send, Store and Optional Fax ¹ |
| Processor Speed | Canon Dual Custom Processor (Shared) |
| Control Panel | 10.1 inch TFT LCD WSVGA Colour Touchpanel |
| Memory | Standard: 3.0GB RAM |
| Hard Disk drive | Standard: 250GB Maximum: 1TB |
| Interface Connection | Network Standard: 1000Base-T/100Base-TX/10Base-T, Wireless LAN (IEEE 802.11 b/g/n) Optional: NFC Others Standard: USB 2.0 x2 (Host), USB 3.0 x1 (Host), USB 2.0 x1 (Device) Optional: Serial Interface, Copy Control Interface |
| Paper input (Standard) | 1,500 sheets x 2 Sheet cassettes + 550 sheets cassettes x 2 cassettes (80gsm) 100 sheets Multi-purpose tray(80gsm) |
| Paper input (Option) | Additional 3,500 sheets (POD DECK LITE-C1 or PAPER DECK UNIT-E1) |
| Maximum paper input capacity | 7,700 sheets (80gsm) |
| Paper output capacity | With Copy Tray: 250 sheets (80gsm) With External Finishers: Max. 3,500 sheets (A4). With Shift Tray: 500-sheets (A4, 80gsm) |
| Finishing capabilities | Collate, Group, Offset. With External finisher: Staple, Saddle Stitch, Hole Punch, Insertion, C & Z folding |
| Supported media types | <u>Upper Left/Right Cassettes(1/2):</u> Thin paper, Plain paper, Recycled paper, Colour paper, Heavy paper, Pre-punched paper, Letterhead, Bond paper <u>Lower Cassettes (3/4):</u> Thin paper, Plain paper, Recycled paper, Colour paper, Heavy paper, Pre-punched paper, Letterhead, Bond paper, Tab paper*. *Tab paper can be fed from both cassette 3 & 4 when the optional TAB FEEDING ATTACHMENT KIT-B1 is installed. <u>Multi-purpose tray:</u> Thin paper, Plain paper, Recycled paper, Colour paper, Heavy paper, Pre-punched paper, Bond, Transparency, Labels, Letterhead, Tab paper, Tracing ² <u>POD DECK LITE-C1:</u> Thin paper, Plain paper, Recycled paper, Colour paper, Heavy paper, Pre-punched paper, Letterhead, Bond paper, Transparency, Labels, Tab paper <u>PAPER DECK UNIT-E1:</u> Thin paper, Plain paper, Recycled paper, Colour paper, Heavy paper, Pre-punched paper, Letterhead, Bond paper |
| Supported media sizes | <u>Upper Left/Right Cassettes(1/2):</u> Standard size: A4, B5 <u>Lower Cassettes (3/4):</u> Standard size: A3, A4, A4R, A5R, B5, B5R Custom size: 139.7 mm x 182 mm to 297 mm x 431.8 mm <u>Multi-purpose tray:</u> Standard size: A4, A4R, A3, A5R, B5, B5R Custom size: 100 mm x 148 mm to 297 mm x 431.8 mm Free size: 100 mm x 182.2 mm to 297 mm x 431.8 mm <u>POD DECK UNIT-C1:</u> A3, A4, A4R, A5R, and Custom Size (139.7 mm x 182 mm to 297 x 431.8 mm) <u>PAPER DECK UNIT-E1:</u> A4 |
| Supported media weights | Cassettes: 52 to 220 gsm Multi-purpose tray: 52 to 256 gsm Duplex: 52 to 220 gsm |
| Warm-up Time | From Power On: 30 Seconds or Less From Sleep Mode: 30 Seconds or Less Quick Startup Mode: 4 Seconds ³ |
| Dimensions (W x D x H) | 670 mm x 779 mm x 1,220 mm |
| Installation Space(W x D x H) | 1,362 mm x 1,353 mm (Basic: Only Multi-purpose tray + Cassette drawers open + Copy Tray) 2,407 mm x 1,353 mm (Fully configured: Includes Booklet finisher + A3 Paper Deck + Insertion and folding unit + Puncher unit + Cassette drawers open) |
| Weight | Approx. 234kg ⁴ |

Print Specifications

| | |
|-----------------------------------|--|
| Printing method | Monochrome laser beam printing |
| Print Speed | <u>iR-ADV 6555i/6555i PRT</u> 32 ppm (A3) 55 ppm (A4) 40 ppm (A4-R) 35 ppm (A5R) <u>iR-ADV 6565i:</u> 32 ppm (A3) 65 ppm (A4) 47 ppm (A4-R) 35 ppm (A5R) <u>iR-ADV 6575i:</u> 37 ppm (A3) 75 ppm (A4) 54 ppm (A4-R) 35 ppm (A5R) |
| Print Resolution | 1,200 dpi x 1,200 dpi, 600 dpi x 600 dpi |
| Page description languages | UFR II, PCL 5e/6 (standard) Genuine Adobe PostScript Level 3 (Option) |

Double Sided Printing

Automatic (Standard)

Direct Print

Direct printing available from USB memory key, Advanced
space, Remote UI and Web Access⁵
Supported file types: TIFF, JPEG, PDF and XPS.

Printing from mobile and cloud

A range of software and MEAP-based solutions is available to
provide printing from mobile devices or internet-connected
devices and cloud-based services depending on your
requirements. Please contact your sales representative for
further information.

FonTS

PCL fonts: 93 Roman, 10 Bitmap fonts, 2 OCR fonts, Andalé
Mono WT J/K/S/T* (Japanese, Korean, Simplified and
Traditional Chinese)
*Requires optional PCL INTERNATIONAL FONT SET-A1.

Operating System

PS fonts: 136 Roman
UFR II: Server 2003/Server 2003 R2Vista/Server 2008/Windows
7/Server 2008 R2/Windows 8/Server 2012//Windows 8.1/Server
2012 R2/Windows 10, MAC OS X (10.5.8 or later)

PCL: Server 2003/Server 2003 R2Vista/Server 2008/Windows
7/Server 2008 R2/Windows 8/Server 2012//Windows 8.1/Server
2012 R2/Windows 10

PS: Server 2003/Server 2003 R2Vista/Server 2008/Windows 7/
Server 2008 R2/Windows 8/Server 2012//Windows 8.1/Server
2012 R2/Windows 10, MAC OS X (10.5.8 or later)

PPD: MAC OS 9.1 or later, MAC OS X (10.3.9 or later), Windows
Vista/Windows 7/Windows 8/Windows 8.1/Windows10

SAP Device Types are available via the SAP Market Place.
Please refer to <http://software.canon-europe.com/> for
availability of print solutions for other operating systems and
environments including AS/400, UNIX, Linux and Citrix.
Some of these solutions are chargeable.

Copy Specifications¹

Copy Speed

iR-ADV 6555i: 32 ppm (A3), 55ppm (A4), 40 ppm (A4R),
35 ppm (A5R)
iR-ADV 6565i: 32 ppm (A3), 65 ppm (A4), 47 ppm (A4R),
35 ppm (A5R)
iR-ADV 6575i: 37 ppm (A3), 75 ppm (A4), 54 ppm (A4R),
35 ppm (A5R)

First-Copy-Out Time

iR-ADV 6555i: Approx. 3.3 seconds or less
iR-ADV 6565i: Approx. 3.3 seconds or less
iR-ADV 6575i: Approx. 3.1 seconds or less

Copy resolution

Reading : 600 dpi x 600 dpi
Printing : 1,200 dpi x 1,200 dpi

Multiple Copies

Up to 9,999 copies

Magnification

25% - 400% (1% Increments)

Preset Reductions

25%, 50%, 64%, 73%, 78%

Preset Enlargements

121%, 129%, 200%, 400%

Scan Specifications¹

Standard type

Colour flatbed scan unit plus 300-sheet duplex automatic
document feeder (1-Pass duplex Colour scan).

Supported media size/s

A3, A4, A4R, A5, A5R

Supported media weight/s

Single-sided scanning: 38 to 220 gsm (BW)
Single-sided scanning: 64 to 220 gsm (CL)
Double-sided scanning: 50 to 220 gsm (BW)
Double-sided scanning: 64 to 220 gsm (CL)

Pull Scan Spec

Colour Network ScanGear2. For both Twain and WIA

Scan Resolution

Supported OS: Windows Vista/7/8/8.1/10
Windows Server 2003/Server 2003 R2/Server 2008/Server
2008 R2/Server 2012/Server 2012 R2

Acceptable Originals

100 x 100 dpi, 150 x 150 dpi, 200 x 100 dpi, 200 x 200 dpi,
200 x 400 dpi, 300 x 300 dpi, 400 x 400 dpi, 600 x 600 dpi
Platen: Sheet, Book, 3-Dimensional Objects (Up to 2kg)
Feeder size: A3, A4, A4R, A5, A5R

Scan Method

Feeder weight
Single-sided scanning: 38 to 220 gsm (BW)
Single-sided scanning: 64 to 220 gsm (CL)
Double-sided scanning: 50 to 220 gsm (BW)
Double-sided scanning: 64 to 220 gsm (CL)
Send functionality available on all models
Scan to USB Memory Key: Available on all models
Scan to Mobiles or internet-connected devices: A range of
solutions is available to provide scanning to mobile devices or
internet-connected devices depending on your requirements.
Please contact your sales representative for further information.
Scan to cloud-based services: A range of solutions is available
to provide scanning to cloud-based services depending on
your requirements. Please contact your sales representative for
further information.

Scan Speed (BW/Colour; A4)

TWAIN/WIA Pull scanning available on all models
Single-sided (A4, 300 dpi): 120/120 ipm (BW/CL);
Single-sided (A4, 600 dpi): 120/60 ipm (BW/CL);
Double-sided (A4, 300dpi): 240/220 ipm (BW/CL)
Double-sided (A4, 600 dpi) 150/60 ipm (BW/CL)

Paper Capacity

300 Sheets (80 gsm)

Double sided scanning

2-sided to 2-sided (Automatic)

Send Specifications¹

Optional / Standard

Standard on all models

Destination

E-mail/Internet FAX (SMTP), SMB, FTP, WebDAV
LDAP (2,000)/Local (1,600)/Speed dial (200)

Address Book

100 x 100 dpi, 150 x 150 dpi, 200 x 100 dpi, 200 x 200 dpi,
200 x 400 dpi, 300 x 300 dpi, 400 x 400 dpi, 600 x 600 dpi

Send resolution

100 x 100 dpi, 150 x 150 dpi, 200 x 100 dpi, 200 x 200 dpi,
200 x 400 dpi, 300 x 300 dpi, 400 x 400 dpi, 600 x 600 dpi



Technical Specifications

imageRUNNER ADVANCE 6575i/6565i/6555i/6555i PRT

| | |
|---------------------------------------|---|
| Communication protocol | File: FTP, SMB, WebDAV E-mail/I-Fax: SMTP, POP3, I-Fax (Simple, Full) |
| File Format | Standard: TIFF, JPEG, PDF (Compact, Searchable, Apply PDF file protection by Adobe Live Cycle Rights Management™), Optimise for Web, PDF A/1-b), XPS (Compact, Searchable), Office Open XML (PowerPoint, Word) Optional: PDF (Trace&Smooth, Encrypted), PDF/XPS (Digital Signature) |
| Universal Send Features | Original Type Selection, Two-sided Original, Book to Two Pages, Different-size Originals, Density Adjustment, Sharpness, Copy Ratio, Erase Frame, Job Build, Sender's Name (TTI), Select Line, Direct Send, Delayed Send, Preview, Finished Stamp, Job Done Notice, File Name, Subject/Message, Reply-to, E-mail Priority, TX Report, Original Content Orientation, Skip Blank Originals, Detect Feeder Multi Sheet Feed. |
| Fax Specifications¹ | |
| Optional / Standard | Optional on all models |
| Modem Speed | Super G3 33.6 kbps (Up to 3 seconds per page ⁶) |
| Compression Method | MH, MR, MMR, JBIG |
| Resolution | 400 x 400 dpi, 200 x 400 dpi, 200 x 200 dpi, 200 x 100 dpi |
| Sending/Recording Size | A5 and A5R* to A3 *Sent as A4 |
| FAX memory | Up to 6,000 pages ⁶ |
| Speed dials | Max. 200 |
| Group dials/destinations | Max. 199 dials |
| Sequential broadcast | Max. 256 addresses |
| Memory backup | Yes |
| Fax Features | Original Type Selection, Two-sided Original, Book to Two Pages, Different-size Originals, Density for Scanning, Sharpness, Copy Ratio, Erase Frame, Job Build, Specifying the Sender's Name (when sending fax), Sender's Name (TTI), Selecting the Telephone Line (when sending fax), Direct Send, Delayed Send, Preview, Finished Stamp, Job Done Notice, TX Report, Detect Feeder Multi Sheet Feed. |
| Store Specifications | |
| Advanced Space Features | Disabling Advanced space, Storage Filtering, Authentication for Advanced space Log-in, Search Function, Sort Function, Printing a PDF File with a Password, imageWARE Secure Audit Manager Support |
| Memory Media | Standard: USB Memory |
| Security Specifications | |
| Authentication | Standard: Universal Login Manager (Device and Function Level Log-in), User Authentication, Department ID, Authentication, Access Management System Optional: My Print Anywhere secure print (Requires uniFLOW) |
| Data | Standard: Trusted Platform Module (TPM), Hard Disk Password Lock, Hard Disk Drive Erase, Mail Box Password Protection, Hard Disk Drive Encryption (FIPS140-2 Validated) Optional: Hard Disk Drive Mirroring, Hard Disk Drive removal, Data Loss Prevention (Requires uniFLOW) |
| Network | Standard: IP/Mac Address Filtering, IPSEC, TLS Encrypted Communication, SNMP V3.0, IEEE 802.1X, IPv6, SMTP Authentication, POP Authentication before SMTP |
| Document | Standard: Secure Print, Adobe LiveCycle® Rights Management ES2.5 Integration, Encrypted PDF Optional: Encrypted PDF, Encrypted Secure Print, User and Device signatures, Secure Watermarks, Document Scan locking |
| Environmental Specifications | |
| Operating Environment | Temperature: 10 to 30 °C (50 to 86 °F) Humidity: 20 to 80% RH (no condensation) |
| Power source | 220-240V(±10%), 50/60Hz (±2 Hz), 10Amp |

| | |
|---|---|
| Power consumption | Maximum: Approx. 2.4 kW Standby: Approx. 238 Wh Energy Saver Mode: Approx. 237 Wh Sleep mode: Approx. 0.9 W or less ⁷ Typical Electricity Consumption (TEC) rating ⁸ : 4.9 kWh (iR-ADV 6555i/6555i PRT) 6.1 kWh (iR-ADV 6565i) 6.7 kWh (iR-ADV 6575i) |
| Noise levels | Sound Pressure ⁹ Active: 75 dB or Less Standby: 58 dB or Less |
| Consumables | |
| Toner Cartridge/s | C-EXV 36 TONER BK |
| Toner (Estimated Yield @6% Coverage) | 56,000 pages |
| Hardware Accessories | Card Readers: MICARDPLUS FOR ULM, CARD READER-F1, COPY CARD READER ATTACHMENT-A3 Others: TAB FEEDING ATTACHMENT KIT-B1, STAMP INK CRG-C1, UTILITY TRAY-B1 |
| Security Options: | Document Security: DOCUMENT SCAN LOCK KIT-B1, SECURE WATERMARK-B1, ENCRYPTED SECURE PRINT SOFTWARE-D1 Data Security: HDD MIRRORING KIT-J1, 2.5INCH/250GB HDD-N1, 2.5INCH/1TB HDD-P1, REMOVABLE HDD KIT-AL1 |
| System and Controller options: | Print Accessories: PCL INTERNATIONAL FONT SET-A1, PS PRINTER KIT-BC1 Send options: UNIVERSAL SEND SECURITY FEATURE SET-D1, UNIVERSAL SEND DIGITAL USER SIGNATURE KIT-C1, UNIVERSAL SEND TRACE & SMOOTH PDF KIT-A1 Barcode printing: BARCODE PRINTING KIT-D1 EFI-Fiery based controller: IMAGEPASS-Y1, REMOVABLE HARD DISK DRIVE KIT-B4 EFI-Fiery based controller options: FIERY IMPOSE, FIERY COMPOSE, FIERY IMPOSE AND COMPOSE System accessories: WEB ACCESS SOFTWARE-J2, SERIAL INTERFACE KIT-K2, NFC CONTROL PANEL-B1 FAX accessories: SUPER G3 FAX BOARD-AS1, SUPER G3 2ND LINE FAX BOARD-AS1, REMOTE FAX KIT-A1, IP FAX EXPANSION KIT-B1 Other Options: Accessibility accessories: ADF ACCESS HANDLE-A1, VOICE GUIDANCE KIT-G1, VOICE OPERATION KIT-D1 Staple Cartridge: STAPLE CARTRIDGE-X1, STAPLE CARTRIDGE-Y1 |
| Footnotes | ⁽¹⁾ Not available on 6555i PRT ⁽²⁾ Some types of tracing paper cannot be used. ⁽³⁾ The time until key operations can be performed on the touch panel display is 3 seconds or less. ⁽⁴⁾ Including the toner bottle. ⁽⁵⁾ PDF print only from websites. ⁽⁶⁾ Based on ITU-T Standard Chart No. 1 ⁽⁷⁾ 0.9 watt sleep mode may not be possible in all circumstances. Certain network configurations and options may prevent the device from entering deep sleep mode. Please refer to the user guide for more information ⁽⁸⁾ Typical Electricity Consumption (TEC) rating represents the typical electricity consumed by a product during 1 week, measured in kilowatt-hours (kWh). The test methodology is defined by Energy Star (http://www.eu-energystar.org). ⁽⁹⁾ Declared noise emission in accordance with ISO 7779 |
| * Refer to local Canon web site | For full information on options available for the iR-ADV 6500 series, please refer to the specification tables on your local Canon web site. |

Software and Solutions



Certifications and compatibility



Canon Inc.

| | | |
|--|-----------|--|
| Canon (UK) Ltd Woodhatch Reigate Surrey RH2 8BF Telephone no 01737 220000 Facsimile 01737 220022 canon.co.uk | canon.com | Canon Ireland 3006 Lake Drive Citywest, Saggart Co. Dublin, Ireland canonireland.com Telephone No: 01 2052400 Facsimile No: 01 2052525 |
|--|-----------|--|

English edition
© Canon Europa NV, 2016



Hay's Lane
London
SE1 2HB
Tel: 020 7536 2300
Email:
sales@ommdigital.co.uk
www.ommdigital.co.uk